



Both the SD430U and XD430U will appeal to educators and business presenters in so many ways

Bright, Lightweight and Portable all at an Affordable Cost

The SD430U/XD430U are ultra-portable projectors that shine bright at 2500 ANSI lumens. These DLP™ projectors support an impressive 2000:1 contrast ratio, a compact design, and are lightweight for convenient portability, setup, and storage. These XGA and SVGA projectors include data and video connectivity options, as well as monitor loop-through, making them both an ideal choice for business and education environments that require a bright and flexible projector.

- DLP™ Technology
- XD430U Native XGA and SD430U Native SVGA resolution
- 2500 ANSI Lumens and 2000:1 contrast ratio
- Light weight at 5.7lbs
- Up to a 4000 hours lamp life (low mode)
- Instant shut down
- RS232C communication support
- Anti-theft security hook

SD430U | XD430U

DLPTM PROJECTOR



Diagonal Size	SCREEN		DISTANCE FROM SCREEN (L)				Hd
	inch	cm	Max.Zoom	Min.Zoom	inch	cm	
40	102	32	81	24	61	3.5	8.8
60	152	48	122	36	91	5.2	13.3
80	203	64	163	48	122	7.0	17.7
100	254	80	203	60	151	8.7	22.1
150	381	120	305	90	229	13.1	33.2
200	508	160	406	120	305	17.4	44.2
250	635	200	508	150	381	21.8	55.3
300	762	240	610	180	457	26.1	66.3

Unit measured in inches. *Hd is distance from lens axis to image bottom.

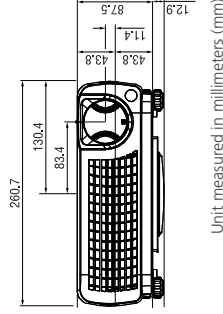
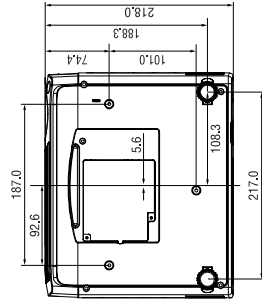
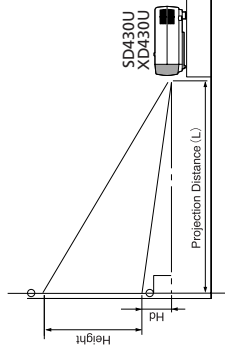

Unit measured in millimeters (mm)



MITSUBISHI DIGITAL ELECTRONICS AMERICA, INC.

Presentation Products Division
Toll Free: 888.307.0349
Email: prodinfo@mdea.com
www.mitsubishi-presentation.com

Canada
Mitsubishi Electric Sales Canada Inc.
Information Technologies Group
Phone: 905.475.7728
www.mitsubishielectrc.ca



DISPLAY TECHNOLOGY
0.55", 1-Chip DMD, 12 deg. DDR, DDP2000
(XD430U) 1024x768 (Total 786,432 pixels) 550 Video Lines
(SD430U) 800x600 (Total 480,000 pixels) 500 Video Lines

BRIGHTNESS
2500 ANSI Lumens
CONTRAST RATIO
2000 : 1 (on/off)
ZOOM/FOCUS
Manual Focus & Zoom Lens
PROJECTION LENS
F= 2.4-2.6
THROW RATIO
1.63-1.97
OFF SET AXIS
7.9:-1
PICTURE SIZE
40-300 inches diagonal
COLOR WHEEL
4 segment (R/G/B/W)
SOURCE LAMP
230W (Shut Off Time 2000 Hrs) with Low Mode (184W: Shut Off Time 4000 Hrs)
PC COMPATIBILITY
(XD430U) 640x480 – 1024x768 + Compressed 1280x1024, Sync on Green available
(SD430U) 640x400 – 800x600 + Compressed 1024x768, Sync on Green available

VIDEO COMPATIBILITY
NTSC/NTSC 4.43/PAL (including PAL-M, N) /SECAM/PAL-60, Component Video: 480i/p (525/p), 576i/p (625/p), 720p (750p), 1080i (1125i 60Hz), 1080i (1125i 50Hz),

INPUT TERMINALS
RGB: Mini D-sub 15pin x 2
Audio: Stereo mini jack (ø 3.5 mm) x 1
Video: RCA x 1 + S-VIDEO x 1

OUTPUT TERMINAL
RGB: Mini D-sub 15-pin x1
Audio: Stereo mini jack (ø 3.5 mm) x 1
Video: DC OUT; 5V 1.5A (Max)

COMMUNICATION TERMINAL
USB terminal for Page Up/Down, RS-232C DSUB 9 pin x 1
SCANNING RATE
[H] 15 - 80 kHz, [V] 50 - 85 Hz, [Dot Clock] max 110 MHz
AUDIO SPEAKER
2 W Mono
HEIGHT ADJUSTER
Front lifting leg 1/Rearward lifting leg 2

HAND REMOTE UNIT
1) Projector fully control
2) Power Point Page Up/Down via USB
3) USB memory operation

POWER CONSUMPTION
280W/2.8A
DIMENSION
10.3" x 10.4" x 3.4" (261 x 265 x 87 mm) (W x H x D)
WEIGHT
5.7 lbs. (2.6 kg.)

POWER REQUIREMENTS
AC 100-240V, 50/60 Hz
FAN NOISE
32 dBA (Lamp Low Mode)

SUPPLIED ACCESSORIES
• Remote control
• Power cable
• VGA (D-sub) cable
• Composite cable
• User Manual CD
• Quick Start Guide & Safety Manual

OPTIONAL ACCESSORIES
Replacement Lamp (VLT-XD430LP), Hard Rolling Case (DKT1-ATAC), Ceiling Mount (PROJ-UCM), and Soft Carrying Case (XL1-SSCC)

WARRANTY
(XD430U) 3-Years on Parts and Labor, 3-Years or 10,000-hours on the TL-DLPTM DMD
Chip, 3-Years Express Replacement Assistance (ERA), 90-Days on lamp

(SD430U) 2-Years on Parts and Labor, 3-Years or 10,000-hours on the TL-DLPTM DMD
Chip, 2-Years Express Replacement Assistance (ERA), 90-Days on lamp

OUTSTANDING FEATURES
• Quick shutdown & start
• 3D-YC
• 2-RGB Input/Monitor Output
• Password Lock (Menu access only)
• RS232C Communication
• Anti-theft security hook
• Wireless Support DC output

©2006 Mitsubishi Digital Electronics America, Inc. Standard features, options and specifications subject to change without notice. The DLPTM logo and DLPTM medallion are trademarks of Texas Instruments. Microsoft, Windows, and the Windows logo are registered trademarks of Microsoft Corporation. Mac and the Mac logo are trademarks of Apple Computer, Inc. registered in the U.S. and other countries. All other trademarks are the property of their respective holders.
*The projector lamp contains mercury. Please dispose of properly.

PP6016-04/06-15M-LITXD430USD430U