

# Panasonic

ideas for life

## PT-RZ470 PT-RW430

1-Chip DLP™ Projectors

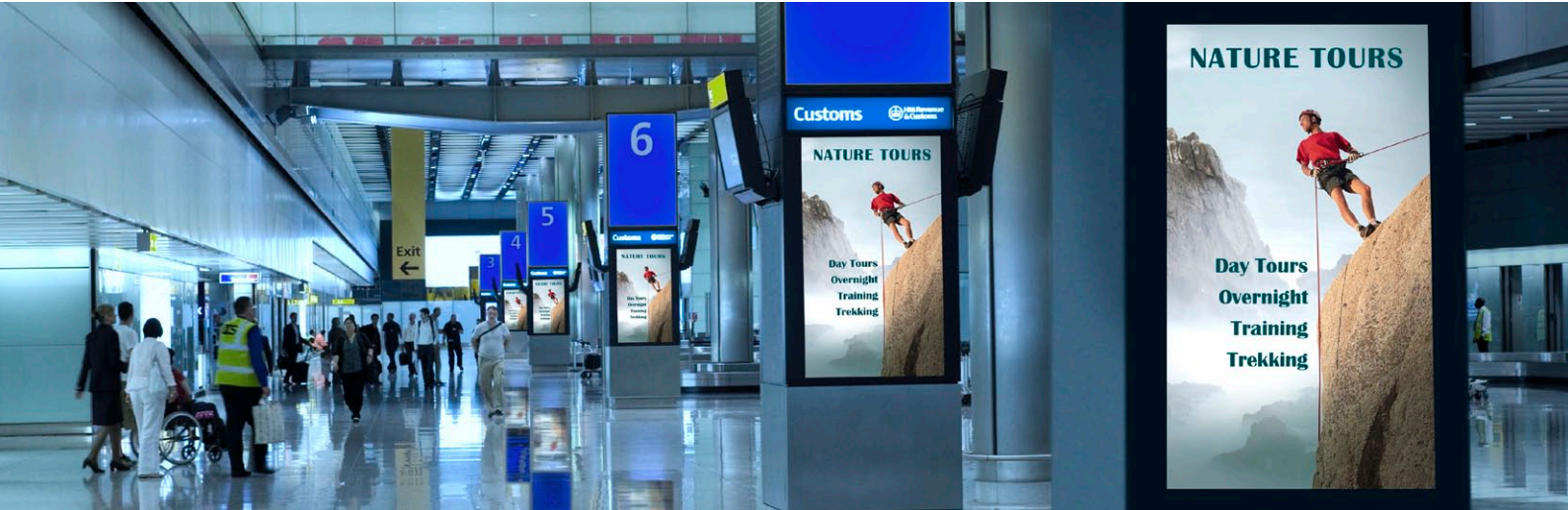

**Solid Performance.**  
**LED/Laser Projectors for Professionals.**





## Going beyond conventional projection

Many projector issues have been addressed with the new LED/Laser-combined light source. From the moment you turn on a SOLID SHINE projector, you'll notice the difference with the quick start and immediate full brightness. There are no more lamps or air filters, so you enjoy maintenance-free use for about 20,000 hours\*1 while maintaining excellent brightness and picture quality. To enhance permanent installation use, we've added DIGITAL LINK support so you can transmit video, audio and control signals up to 100 meters (328 feet) over a single LAN cable.\*2 System capabilities have also been improved with 2x zoom and an exceptionally wide lens shift range, thus providing superb flexibility for easy first time and replacement installations. The Total Cost of Ownership (TCO) has also been reduced because you no longer have to keep replacement lamps on hand. And the projector is loaded with features for professional integration, such as Portrait mode, a Multi Screen Support System and 3D projection. The next-generation PT-RZ470/RW430 expands projection capabilities in museums, digital signage, and more.



No Maintenance  
**20,000**  
HOURS

**DIGITAL LINK**  
SINGLE CABLE SOLUTION

- \*1 A guideline for light source replacement. The maintenance-free period may be shortened due to environmental conditions.
- \*2 Use a CAT5e (STP) cable or higher.

## SOLID SHINE series uses the newly developed LED/Laser-combined light source



SOLID SHINE series projectors provide solid reliability and long-lasting brightness unprecedented by conventional lamp-based projectors.

### Approximately 20,000 hours of maintenance-free operation

No need to replace the light source or air filter, providing a dramatic reduction in the Total Cost of Ownership (TCO).

### Long-lasting picture quality

Excellent picture quality and brightness are maintained for a long time.

### Superb color reproduction

Beautiful, vivid colors exceeding the levels of conventional projectors.

### Quick start, quick off

The image appears almost instantly upon powering up, and there is no need for cooling after turning the power off. The power can be turned on immediately after being turned off, and it can be turned on/off as many times as you want.

PT-RZ470/RW430 Optical Structure Image

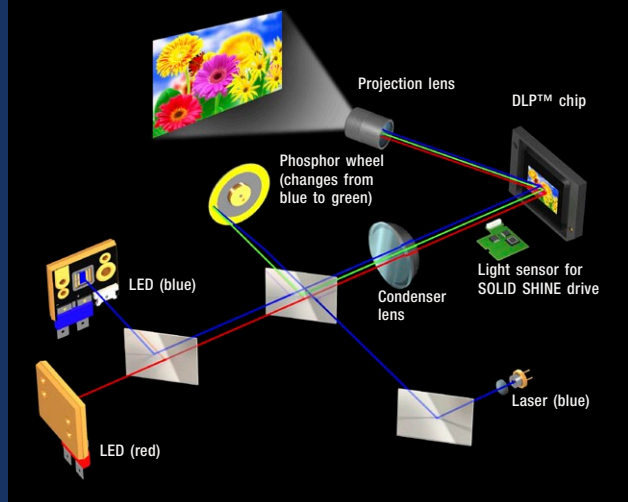

<b>PT-RZ470K</b>
<b>Full HD</b>
<b>3,500 lm</b>

<b>PT-RW430K</b>
<b>WXGA</b>
<b>3,500 lm</b>



<b>PT-RZ470W</b>
<b>Full HD</b>
<b>3,500 lm</b>

<b>PT-RW430W</b>
<b>WXGA</b>
<b>3,500 lm</b>

Both models are offered in a black (PT-RZ470K/RW430K) or white (PT-RZ470W/RW430W) cabinet.

# Expand projection capabilities in museums, digital signage, and more

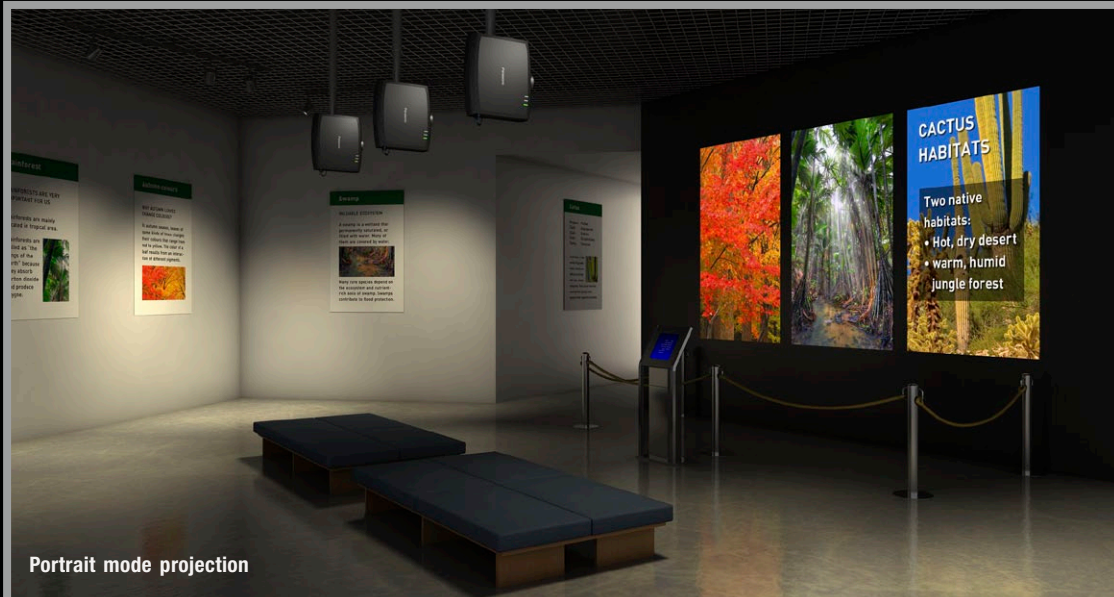

Portrait mode projection



3D projection

The PT-RZ470/RW430 projectors feature enhanced installation flexibility and various projection capabilities. By mounting the optional ET-PKR100P bracket, they can project in portrait orientation. Multiple portrait images bring about a strong new impact. Lining up several portrait projection screens vertically, with the edge blended, creates a single, long screen. And 3D projection using active shutter glasses is also possible. Features such as these enable fresh new visual expression in places like museums, public spaces, and company showrooms.



Multi-screen portrait projection with edge blending

# Long-Lasting Reliability and High Picture Quality

## The LED/Laser-Combined Light Source Enables Approx. 20,000 Hours of Continuous Operation

This new light source requires no maintenance for approximately 20,000 hours. In many cases, this means no maintenance until your next refresh cycle. Naturally, there are no lamp burn-out problems during use, so reliability is further increased. There is also no filter to clean due to carefully engineered sealed optics. As a consequence, running cost is dramatically lowered because of the savings on lamp costs, maintenance labor and hassle of stocking lamps.

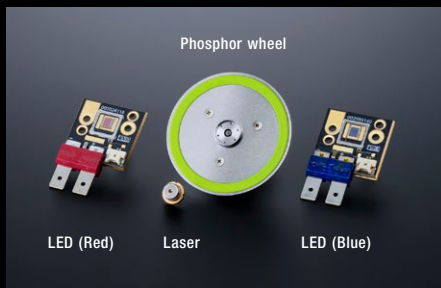

## Bright, Beautiful Picture Quality for a Long Period of Time

The PT-RZ470/RW430 features 3,500 lumens of brightness. Rate of brightness deterioration in the LED/Laser-combined light source is extremely slow compared to lamp-based projectors. The SOLID SHINE drive uses a built-in sensor to constantly detect the light intensity of the light source and correct corresponding changes in white balance. This all helps to maintain excellent picture quality for a long period of time. Contrast is outstanding too, at 20,000:1, and images are reproduced with a wide dynamic range. The PT-RZ470 features a Full-HD (1920 × 1080) DLP™ chip, allowing highly detailed Full-HD images without resizing.

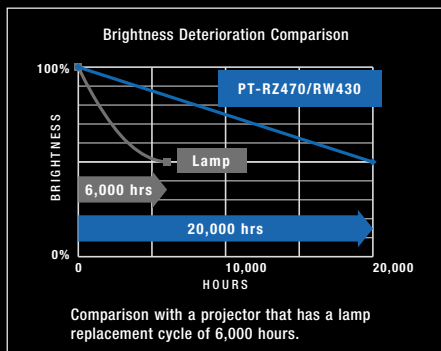

## Superior Color Reproduction

The LED/Laser-combined light source has a higher level of color purity than an ordinary lamp, allowing it to achieve color reproduction with wider color space. Colors are more vibrant than those of conventional projectors.

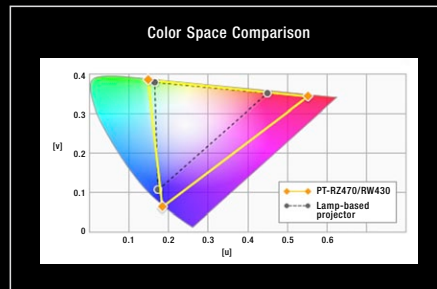

## 30× Drive\*<sup>2</sup> Switching Prevents Color Breaking

In 1-chip DLP™ system projectors with conventional lamp, a color wheel is used for time-division multiplexing in a method where the human eye combines the result to achieve a full-color palette. In the PT-RZ470/RW430, this is done by on/off switching of the LED/Laser-combined light source. A unique Panasonic power supply circuit provides time-division multiplexing with ultrafast 30× drive.\*<sup>1</sup> The resulting, high-definition images exhibit virtually no color breaking.\*<sup>2</sup>

## Heat Pipe Cooling System Maintains Stable Operation up to 45 °C (113 °F)\*<sup>3</sup>

Laser cooling is performed by releasing the heat to cooling fins, then cooling with a heat pipe cooling system. This suppresses temperature rises inside the projector and allows stable operation up to an ambient temperature of (45 °C) 113 °F.\*<sup>3</sup> The use of this heat pipe-cooled system also achieves quiet operation of 29 dB,\*<sup>4</sup> enabling viewers to concentrate on the presentation or on quiet movie scenes.

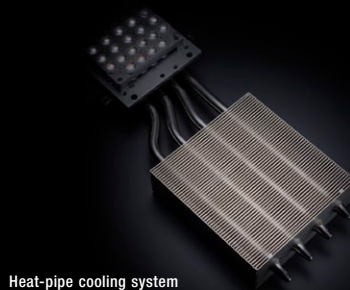

## Dust-Resistant Structure with an Airtight Optical Block

The area between the LED/Laser to the DLP™ chip and prism is hermetically sealed to form an airtight structure for the optical block, the heart of the projector. This resists the effects of dust and other particles in the air, and enables use of the projector in a wide range of environments.

## The Daylight View Basic Ensures Clear Images Even in Brightly Lit Rooms

Panasonic's Daylight View Basic technology achieves sharp, easy-to-see images by clearly reproducing the details in dark image areas, which were previously difficult to see in brightly lit rooms. A built-in sensor measures the ambient light, and the Daylight View Basic function adjusts the halftone color and brightness level according to the surrounding illumination.



## DICOM Simulation Mode\*<sup>5</sup>

This imaging mode is similar to DICOM part 14, which is a medical imaging standard. It reproduces X-ray images with remarkable clarity.

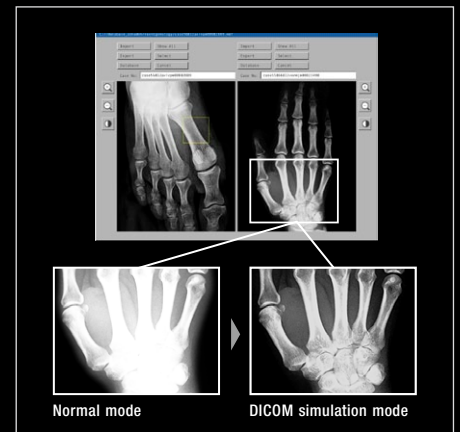

## Rec. 709 mode for HDTV projection

Optimal color reproduction can be achieved by selecting this mode, compliant with ITU-R Recommendation BT.709, when images from an HDTV source are projected.

\*1 Picture mode: Dynamic. 10× drive in other picture modes. The rate for each vertical sync/blanking interval, with R/G/B light source switching set to 1×.

\*2 A condition in which incorrect color expression causes color flickering.

\*3 The operating temperature range is 0 °C to 40 °C (32 °F to 104 °F) when used in locations from 1,400 m to 2,700 m (4,593 ft to 8,858 ft) above sea level. If the

ambient temperature exceeds 35 °C (95 °F), the light output may be reduced to protect the projector.

\*4 LIGHT POWER mode: LOW. 35 dB with LIGHT POWER mode set to NORMAL.

\*5 This product is not a medical instrument. Do not use it for actual medical diagnosis.



## Expanding Installation Flexibility

### Versatile First-Time and Replacement Installations

- **2x Zoom Lens:** For a 120-inch-diagonal wide screen, the projection distance extends from approximately 3.9 m (12.8 ft) to approximately 7.8 m (25.7 ft).

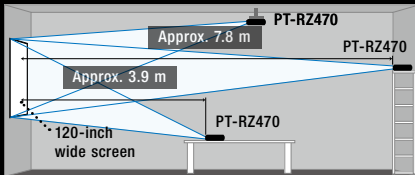

- **Horizontal/Vertical Lens Shift:**

The wide shift range accommodates various room sizes and shapes. When lights or ventilation holes are located in the ceiling mounting site, you can simply relocate the projector to avoid them.



- **Lens-Centered Design:**

A lens-centered, symmetrical design provides ease of installation, eliminating the need for any special considerations when planning the installation site.

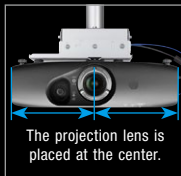

signals can be transmitted up to 100 m (328 ft) over a single LAN cable.\*<sup>2</sup> It allows projector connection with only one cable, making it ideal for ceiling-mounted and other permanent installations. Also, because control signals can be simultaneously transmitted, the ET-YFB100G input signal can easily be switched with the wireless remote control that is included with the projector. The projector can be controlled by either serial or LAN communication.



ET-YFB100G terminals

- **Also Supports Other Manufacturers' Peripheral Equipment:** DIGITAL LINK is an original function added to technology based on the transmission standards used in Creston's DigitalMedia 8G+, Extron's XTP Systems, etc. Signals from the ET-YFB100G can also be relayed to a non-DIGITAL LINK-ready projector by using another manufacturer's equipment based on the same technology.\*<sup>6</sup>

For details on other manufacturers' equipment, visit our Projector Global Web Site:  
**panasonic.net/avc/projector**

### DIGITAL LINK Transmits Digital Signals up to 100 m (328 ft) with a Single Cable

- **Optional ET-YFB100G Digital Interface Box for Easy Setup:** By combining the optional ET-YFB100G Digital Interface Box, with its HDMI and other input terminals, uncompressed HD digital video, audio and control

### Abundant Connection Terminals, Including HDMI

Interfaces include HDMI and DVI-I inputs. The serial terminal (RS-232C) has an Emulate function that lets you continue using existing control systems when replacing previous Panasonic



models. It is also possible to output audio during Standby mode.\*<sup>7</sup> This is convenient when connecting an external audio system through the projector.\*<sup>8</sup> A closed caption decoder is built in.

### Easy Remote Monitoring and Control over a LAN

Web browser on a computer connected through a wired LAN system lets you remotely operate projectors and check their status. An e-mail messaging function can also notify you the overall projector status. In addition, Multi Projector Monitoring and Control Software Ver. 2.8 is available for monitoring and controlling multiple Panasonic projectors from a single PC. The wired LAN terminal is compatible with PLink™ (class 1), an open protocol that is used by many manufacturers, to enable integrated control of systems that contain different brands of projectors.

### Compatible with Crestron RoomView™

The LAN terminal allows a computer connected to the network to use Crestron RoomView™ application software to manage and control system devices.

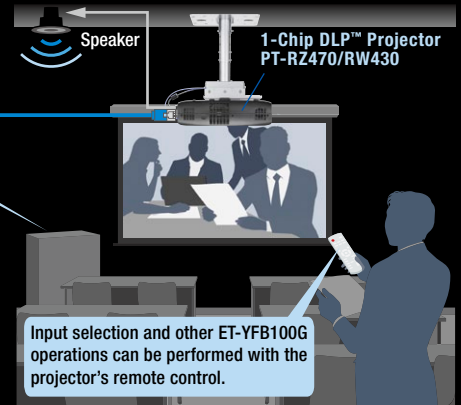
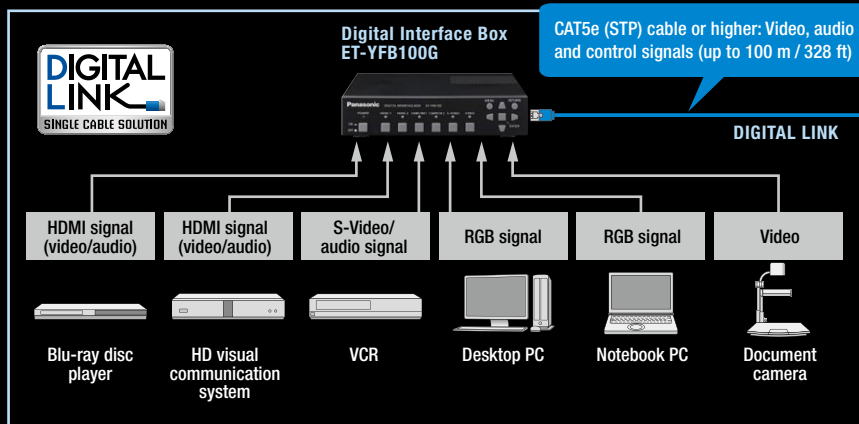

\*6 Input selection and other ET-YFB100G operations can be performed only when connecting to a DIGITAL LINK compatible projector.

\*7 Requires menu selection.

\*8 Audio monitoring requires external speakers and an audio amplifier.



## Professional System Integration

### Flexible 360-Degree Installation

The projectors can be rotated vertically. This means you can install one at any up-and-down angle you want, to accommodate different installation conditions.



### Portrait Mode Capability

Portrait mode allows the projector to be mounted with its side surface facing down,\*<sup>9</sup> for projecting onto a long, vertical screen. This provides a fresh visual effect in museums, public spaces, shopping centers, company showrooms, and similar locations. The optional ET-PKR100P ceiling mount bracket for portrait projection is also available.



### Multi-Screen Support System Seamlessly Connects Multiple Screens

- **Edge Blending:** The edges of adjacent screens can be blended and their luminance controlled.
- **Color Matching**\*<sup>10</sup>: This function corrects for slight variations in the color reproduction range of individual projectors.

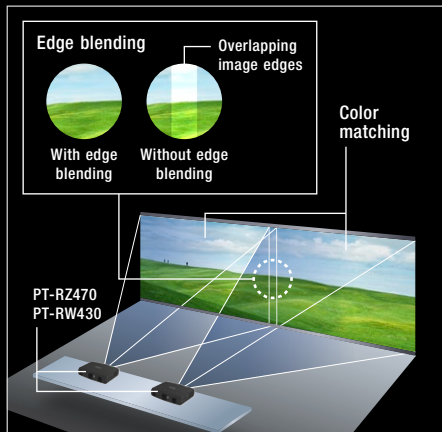

### Multi-Unit Brightness Control

This function automatically corrects the brightness fluctuations that occur over time in the individual projectors of a multi-screen system. Up to eight projectors can be controlled by connecting to each other via a hub, and this can be increased to a maximum of 2,048 projectors by using "Multi Projector Monitoring & Control Software."\*<sup>11</sup>

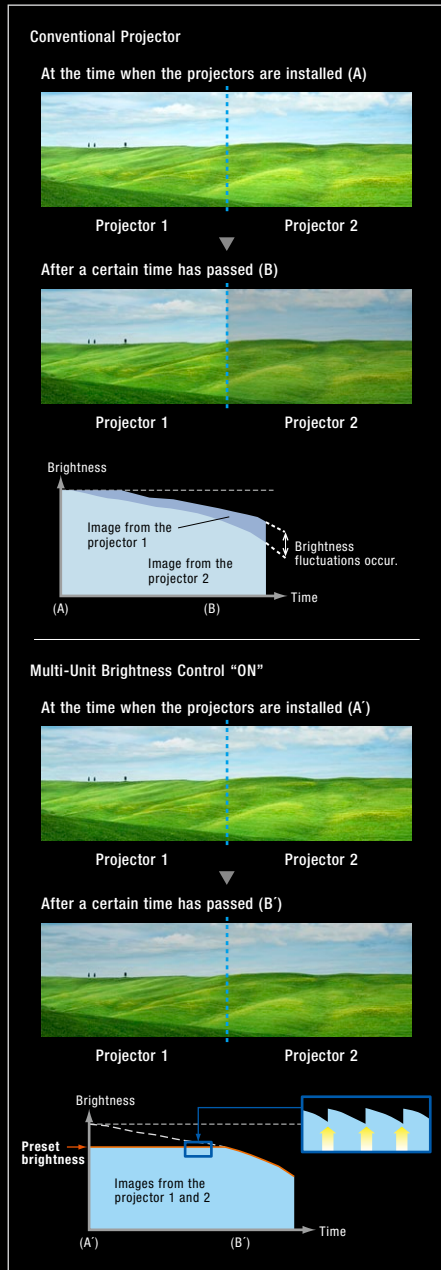

### 3D Projection Capability

The PT-RZ470/RW430 can deliver impressive 3D images when viewed with active 3D glasses.\*<sup>12</sup>



- **HDMI input terminal supports 3D:** The HDMI input terminal supports 3D. Connect a 3D Blu-ray player to the projector to project Blu-ray 3D images.
- **DLP™ Link™:** You can build a 3D system without the need for the optional transmitter. Configuration: 3D Contents + Reproduction apparatus + 3D Glasses\*<sup>12</sup> (DLP™ Link™ system)
- **External transmitter connection capability:** A 3D system can be configured by connecting an additional 3D IR transmitter to the projector's 3D SYNC OUT terminal.

### Image Appears Immediately—No Need for Cooling after Use

Images do not appear quickly with lamp-based projectors because the projector requires time to warm up. With the PT-RZ470/RW430, the image appears almost instantly. There's also no cooling time required when turning the power off, so you can quickly turn the projector on and off as many times as needed.

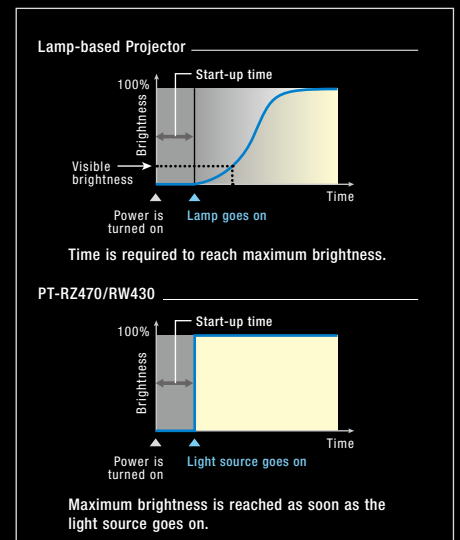

\*<sup>9</sup> The projector itself cannot be set vertically by itself. Also, the side with terminals should be facing downward. Using the projector at an angle that exceeds the available angle of 210° may result in malfunctions. If setting up the projector at an angle that exceeds 210° is required, consult your dealer.

\*<sup>10</sup> Consult your dealer for information about color matching software.

\*<sup>11</sup> If the temperature of the projector's surroundings is elevated, light output may be

reduced in order to protect the projector unit. If this software is used for the brightness control of multiple projectors, please ensure that as far as possible the temperature of the surroundings is the same for all projectors.

\*<sup>12</sup> To view 3D images, active-shutter 3D glasses are separately required. (In the active shutter system, the right/left liquid crystal shutter is opened and closed alternately according to projected images.)

## 24/7 Operation

Ordinary lamps are not well suited to continuous operation. Because the PT-RZ470/RW430 does not use a lamp, has efficient cooling system and uses DLP™ chip that has a long life, they are capable of 24/7 operation.

## Scheduling Function

Scheduled operation is possible using the built-in timer function, without having to use a PC and software.

## Effective Theft Prevention with the Startup Logo

You can change the default Panasonic start up logo to any logo you want. A new logo can be easily uploaded by connecting a computer to the PT-RZ470/RW430 through the LAN or serial connection by using the Logo Transfer Software.\*13 An abundance of other security

measures are also included, such as a security bar, Key lock, and Security Password. This is very effective for preventing theft.



## 15 m (49 ft) Long-Range Wireless Remote Control

A unique ID number can be assigned to each projector using the supplied wireless remote control unit. This allows operation of a desired projector when multiple units are set up at the same location. Three frequently used functions can be assigned to the Function buttons for instant recall.



## Eco Management Functions

A number of functions are provided to reduce power consumption. You can easily set the Eco

Management functions according to operating conditions by using the "ECO" button on the remote control.

- Selectable light source modes:
  - Normal:** Prioritizes brightness.
  - EcoSave 1:** Reduces power consumption by approximately 20% on average while leaving brightness almost unchanged.
  - EcoSave 2:** Minimizes brightness reduction while reducing power consumption by approximately 30% on average.
  - Low:** Prioritizes low power consumption.
- Adjusts the brightness according to ambient light conditions, and reduces the light source power.
- Reduces the light source power when there is no signal input or the projector is in AV Mute mode.

## Ecology-Conscious Design

- Lamp-free (no mercury)
- Low heat dissipation
- RoHS Directive compliant
- No halogenated flame retardants are used in the cabinet.
- Non-coated cabinet for easy recycling (for the PT-RZ470W/RW430W only)
- Lead-free glass is used for the lens.
- Light source mode is selectable to reduce power consumption.
- "ECO" button on the remote control for easy setting up of Eco Management functions.
- Standby power consumption of only 0.5 W has been achieved. (STANDBY MODE: ECO)
- An Auto Off Timer switches the projector to standby mode when no input signal is received for a preset time.

## Options

### ET-PKR100P

Ceiling mount bracket for portrait



### ET-PKR100H

Ceiling mount bracket for high ceilings



### ET-PKR100S

Ceiling mount bracket for low ceilings



### ET-YFB100G

Digital interface box



Brackets included for various installation needs, including server rack (EIA standards) mounting.



## Projection Distance

unit: meters (feet)

### PT-RZ470 (16:9 aspect ratio)

Projection size [diagonal]	Projection distance		Height from the edge of screen to center of lens
	Min [wide]	Max [telephoto]	
1.02 / 40	1.3 (4.1)	2.6 (8.5)	-0.12 - 0.49 (-0.4 - 1.6)
1.52 / 60	1.9 (6.3)	3.9 (12.8)	-0.17 - 0.73 (-0.6 - 2.4)
2.03 / 80	2.6 (8.5)	5.2 (17.1)	-0.23 - 0.98 (-0.8 - 3.2)
2.54 / 100	3.2 (10.6)	6.5 (21.4)	-0.29 - 1.22 (-0.9 - 4.0)
3.05 / 120	3.9 (12.8)	7.8 (25.7)	-0.34 - 1.46 (-1.1 - 4.8)
3.81 / 150	4.9 (16.0)	9.8 (32.1)	-0.43 - 1.83 (-1.4 - 6.0)
5.08 / 200	6.5 (21.4)	13.1 (42.9)	-0.57 - 2.44 (-1.9 - 8.0)
7.62 / 300	9.8 (32.2)	19.6 (64.4)	-0.86 - 3.66 (-2.8 - 12.0)

### PT-RW430 (16:10 aspect ratio)

Projection size [diagonal]	Projection distance		Height from the edge of screen to center of lens
	Min [wide]	Max [telephoto]	
1.02 / 40	1.3 (4.2)	2.6 (8.7)	-0.10 - 0.52 (-0.3 - 1.7)
1.52 / 60	2.0 (6.4)	4.0 (13.1)	-0.15 - 0.78 (-0.5 - 2.5)
2.03 / 80	2.6 (8.6)	5.3 (17.5)	-0.21 - 1.03 (-0.7 - 3.4)
2.54 / 100	3.3 (10.9)	6.7 (21.8)	-0.26 - 1.29 (-0.8 - 4.2)
3.05 / 120	4.0 (13.1)	8.0 (26.2)	-0.31 - 1.55 (-1.0 - 5.1)
3.81 / 150	5.0 (16.4)	10.0 (32.8)	-0.38 - 1.94 (-1.3 - 6.4)
5.08 / 200	6.7 (21.9)	13.4 (43.8)	-0.51 - 2.59 (-1.7 - 8.5)
7.62 / 300	10.0 (32.9)	20.1 (65.8)	-0.77 - 3.88 (-2.5 - 12.7)

### PT-RW430 (16:9 aspect ratio)

Projection size [diagonal]	Projection distance		Height from the edge of screen to center of lens
	Min [wide]	Max [telephoto]	
1.02 / 40	1.3 (4.4)	2.7 (8.9)	-0.05 - 0.48 (-0.2 - 1.6)
1.52 / 60	2.0 (6.6)	4.1 (13.4)	-0.08 - 0.71 (-0.2 - 2.3)
2.03 / 80	2.7 (8.9)	5.5 (17.9)	-0.10 - 0.95 (-0.3 - 3.1)
2.54 / 100	3.4 (11.2)	6.8 (22.4)	-0.13 - 1.19 (-0.4 - 3.9)
3.05 / 120	4.1 (13.5)	8.2 (27.0)	-0.15 - 1.43 (-0.5 - 4.7)
3.81 / 150	5.1 (16.9)	10.3 (33.7)	-0.19 - 1.79 (-0.6 - 5.9)
5.08 / 200	6.9 (22.5)	13.7 (45.0)	-0.25 - 2.38 (-0.8 - 7.8)
7.62 / 300	10.3 (33.9)	20.6 (67.6)	-0.37 - 3.57 (-1.2 - 11.7)

\*13 Still images that can be uploaded are limited to 1024 x 768 pixel bitmap files. Also, the application will reduce the number of colors to 191.

## Specifications

Model		PT-RZ470	PT-RW430
Power supply		100–240 V AC, 5.2–2.0 A, 50/60 Hz	
Power consumption		460 W (470 VA) (250 W <sup>1</sup> with LIGHT POWER set to NORMAL, 200 W <sup>1</sup> with LIGHT POWER set to Ecosave1, 178 W <sup>1</sup> with LIGHT POWER set to Ecosave2) (0.5 W with STANDBY MODE set to Eco <sup>2</sup> , 8 W with STANDBY MODE set to NORMAL)	
DLP™ chip	Panel size Display method Pixels	16.5 mm (0.65 in) diagonal (16:9 aspect ratio) DLP™ chip × 1, DLP™ projection system 2,073,600 (1,920 × 1,080) × 1, total of 2,073,600 pixels	16.5 mm (0.65 in) diagonal (16:10 aspect ratio) DLP™ chip × 1, DLP™ projection system 1,024,000 (1,280 × 800) × 1, total of 1,024,000 pixels
Lens		Manual zoom (2.0×), manual focus, F 2.0–3.4, f 21.5–43.0 mm	
Throw ratio		1.46–2.94:1	1.53–3.09:1
Light source		LED/Laser-combined (R, B: LED; G: Laser diode)	
Screen size (diagonal)		1.02–7.62 m (40–300 inches) diagonally, 16:9 aspect ratio	
Brightness <sup>3</sup>		3,500 lm	
Center-to-corner uniformity <sup>3</sup>		90 %	
Contrast <sup>3</sup>		20,000:1 (full on/off)	
Resolution		1,920 × 1,080 pixels (Input signals that exceed this resolution will be converted to 1,920 × 1,080 pixels.)	1,280 × 800 pixels (Input signals that exceed this resolution will be converted to 1,280 × 800 pixels.)
Scanning frequency	HDMI/DVI-I (digital) DVI-I (analog)/RGB YPbPr (YCbCr)	fh: 27–100 kHz, fv: 24–120 Hz, dot clock: 25–162 MHz fh: 15–100 kHz, fv: 24–120 Hz, dot clock: 162 MHz or lower fh: 15.75 kHz, fv: 60 Hz [480i (525i)] fh: 15.63 kHz, fv: 50 Hz [576i (625i)] fh: 31.50 kHz, fv: 60 Hz [480p (525p)] fh: 31.25 kHz, fv: 50 Hz [576p (625p)] fh: 45.00 kHz, fv: 60 Hz [720 (750)/60p] fh: 15.75 kHz, fv: 60 Hz [NTSC/NTSC4.43/PAL-M/PAL60], fh: 15.63 kHz, fv: 50 Hz [PAL/PAL-N/SECAM]	fh: 37.50 kHz, fv: 50 Hz [720 (750)/50p] fh: 33.75 kHz, fv: 60 Hz [1035/60i] fh: 33.75 kHz, fv: 60 Hz [1080 (1125)/60i] fh: 28.13 kHz, fv: 50 Hz [1080 (1125)/50i] fh: 28.13 kHz, fv: 25 Hz [1080 (1125)/25p] fh: 27.00 kHz, fv: 24 Hz [1080 (1125)/24p] fh: 27.00 kHz, fv: 48 Hz [1080 (1125)/24sF] fh: 33.75 kHz, fv: 30 Hz [1080 (1125)/30p] fh: 67.50 kHz, fv: 60 Hz [1080 (1125)/60p] fh: 56.25 kHz, fv: 50 Hz [1080 (1125)/50p]
Video			
Optical axis shift		Vertical: +73%, -48% (manual), horizontal: +27%, -35% (manual)	
Keystone correction range		Vertical: ±40°	
Installation		Ceiling/floor, front/rear	
Terminals	HDMI IN	HDMI 19-pin × 1 (Deep Color, compatible with HDCP)	
	DVI-I IN	480p (525p), 576p (625p), 720 (750)/60p, 720 (750)/50p, 1080 (1125)/60i, 1080 (1125)/50i, 1080 (1125)/25p, 1080 (1125)/24p, 1080 (1125)/24sF, 1080 (1125)/30p, 1080 (1125)/60p, 1080 (1125)/50p, VGA (640 × 480)–WUXGA <sup>4</sup> (1,920 × 1,200), compatible with non-interlaced signals only, dot clock: 25–162 MHz, audio signal: linear PCM (sampling frequencies: 48 kHz, 44.1 kHz, 32 kHz)	
	Digital	DVI-I 29-pin × 1 (DVI 1.0 compliant, compatible with HDCP, compatible with single link only) 480p (525p), 576p (625p), 720 (750)/60p, 720 (750)/50p, 1080 (1125)/60i, 1080 (1125)/50i, 1080 (1125)/25p, 1080 (1125)/24p, 1080 (1125)/24sF, 1080 (1125)/30p, 1080 (1125)/60p, 1080 (1125)/50p, VGA (640 × 480)–WUXGA <sup>4</sup> (1,920 × 1,200), compatible with non-interlaced signals only, dot clock: 25–162 MHz	
	RGB YPbPr/YCbCr	R/B: 0.7 Vp-p, 75 ohms, G: 0.7 Vp-p (G: 1.0 Vp-p for sync on G), 75 ohms, HD/VD, SYNC: TTL, high impedance, positive/negative automatic	
	COMPUTER (RGB) IN	Y: 1.0 Vp-p (including sync signal), Pb/Pr (Cb/Cr): 0.7 Vp-p, 75 ohms	
	VIDEO IN	D-Sub HD 15-pin (female) × 1 (RGB/YPbPr/YCbCr × 1)	
	AUDIO IN	Pin jack × 1	
	AUDIO OUT	M3 (L, R) × 1	
	SERIAL IN	M3 (L, R) × 1	
	LAN / DIGITAL LINK	D-sub 9-pin (female) × 1 for external control (RS-232C compliant)	
	3D SYNC OUT	RJ-45 × 1 (for network and DIGITAL LINK (video/audio/network/serial control) connection, 100Base-TX, compatible with PLink™, HDCP compatible, Deep Color compatible) 1080 (1125)/50i, 1080 (1125)/25p, 1080 (1125)/24p, 1080 (1125)/24sF, 1080 (1125)/30p, 1080 (1125)/60p, 1080 (1125)/50p, VGA (640 × 480)–WUXGA <sup>4</sup> (1,920 × 1,200), compatible with non-interlaced signals only, dot clock: 25–162 MHz	
Cabinet materials		Molded plastic	
Dimensions (W × H × D)		455 × 137 <sup>5</sup> × 415 mm (17-29/32 × 5-13/32 <sup>5</sup> × 16-11/32 in) (lens included)	
Weight <sup>6</sup>		Approximately 11.0 kg (24.3 lbs)	
Operation noise <sup>3</sup>		35 dB (LIGHT POWER mode: NORMAL), 29 dB (LIGHT POWER mode: LOW)	
Operating environment		Operating temperature: 0–45 °C <sup>7</sup> (32–113 °F <sup>7</sup> ), operating humidity: 20–80 % (no condensation)	
Supplied accessories		Power cord (with secure lock) × 1 <sup>8</sup> , wireless remote control unit, batteries for remote control (R6/LR6/AA type × 2), software CD-ROM (Logo Transfer Software, Multi Projector Monitoring & Control Software)	

- \*1 In STANDARD/GRAPHIC picture mode. Measured based on the power consumption rate and a measurement method for the TV receiver.
- \*2 When the STANDBY MODE is set to ECO, network functions such as power on over the LAN network will not operate. Also, only certain commands can be received for external control using the serial terminal.
- \*3 Measurement, measuring conditions, and method of notation all comply with ISO 21118 international standards.
- \*4 WUXGA resolution is supported only when the signals are compliant with VESA CVT-RB (Coordinated Video Timing-Reduced Blanking).
- \*5 With legs at shortest position.
- \*6 Average value. May differ depending on the actual unit.
- \*7 0–40 °C (32–104 °F) between 1,400 m and 2,700 m (4,593 ft and 8,858 ft) above sea level. If the ambient temperature exceeds 35 °C (95 °F), the light output may be reduced to protect the projector.
- \*8 Power cords available (× 2) for the PT-RZ470EA/RW430EA.

### NOTES ON USE

1. Do not install the projector in locations that are subject to excessive water, humidity, steam, or oily smoke. Doing so may result in fire, malfunction, or electric shock.
2. Please observe the following precautions:
  - Never place objects on top of the projector while it is operation.
  - Make sure there is an unobstructed space of 500 mm (1 ft 8 in) or more around the projector's exhaust openings.
  - Do not stack projector units directly on top of one another for the purpose of multiple (stacked) projection. When stacking projector units, be sure to provide the amount of space indicated below between them. These space requirements also apply to installations where only one projector unit is operating at one time and the other unit is used as a backup.
  - Make sure that nothing blocks the projector's air intake and exhaust openings. Also, install the projector so that cool or hot air from other air conditioning equipment does not flow directly

### Dimensions

unit: mm (inches)

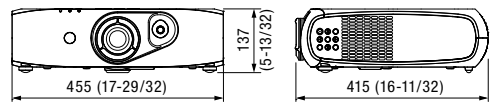

- toward the projector's air intake or exhaust openings.
- Do not install the projector in an enclosed space. If it is necessary to install it in an enclosed space, add a separate ventilation system. If ventilation is insufficient, hot air will accumulate at the intake opening. This may cause the projector's protective circuit to interrupt projector operation.
- If the projector is placed in a box, ensure that the projector's intake and exhaust openings are not blocked. Take particular care to ensure that hot air from the exhaust openings is not sucked into the intake openings.
- To install and use the projector via a method that does not use the adjustable feet in a floor standing installation, fix the projector using the four screw holes for ceiling mounting. (Screw diameter: M4, tapping depth inside the set: 10 mm, torque: 1.25 ± 0.2 N·m)

# Panasonic®

Weights and dimensions shown are approximate. Specifications and appearance are subject to change without notice. Product availability differs depending on region and country. This product may be subject to export control regulations. DLP, DLP logo and DLP Medallion logo are trademarks or registered trademarks of Texas Instruments. The projection distances and throw ratios given in this leaflet are for use only as guidelines. For more detailed information, please consult the dealer from whom you are purchasing the product. The PLink trademark is an application trademark in Japan, the United States, and other countries and regions or registered trademarks. HDMI, the HDMI Logo, and High-Definition Multimedia Interface are trademarks or registered trademarks of HDMI Licensing LLC in the United States and other countries. All other trademarks are the property of their respective trademark owners. Projection images simulated.  
© 2013 Panasonic Corporation. All rights reserved.



For more information about Panasonic projectors, please visit:  
 Projector Global Web Site – [panasonic.net/avc/projector](http://panasonic.net/avc/projector)  
 Facebook – [www.facebook.com/panasonicprojector](http://www.facebook.com/panasonicprojector)  
 YouTube – [www.youtube.com/user/PanasonicProjector](http://www.youtube.com/user/PanasonicProjector)

All information included here is valid as of January 2013.

PT-RZ470G1 Printed in Japan.